

NOTE: If you wish to address the MWD Board of Directors during discussion of an agenda item, or during the PUBLIC FORUM, please complete a Speaker Request card (blue in color) and give it to the Board Secretary. Unless a detailed presentation of an agenda item is required by the Board of Directors, it is requested that each speaker limit comments to FIVE MINUTES. All testimony given before the Board of Directors is tape recorded.

**A G E N D A**  
**BIG BEAR MUNICIPAL WATER DISTRICT**

**BOARD OF DIRECTORS**  
**Regular Meeting**  
**October 20, 2011**

**PLACE:** Big Bear Municipal Water District  
40524 Lakeview Drive, Big Bear Lake, CA 92315

Next Resolution Number: 2011-08

**OPEN SESSION: 1:00 P.M.**

- 1. CALL TO ORDER**
- 2. PLEDGE OF ALLEGIANCE**
- 3. DISCUSSION AND ACTION ON CLOSED SESSION ITEMS**
- 4. REPORTS**
  - A. General Manager
  - B. Lake Manager
  - C. Legal
  - D. Committee
  - E. Other
- 5. CONSENT CALENDAR**
  - A. Minutes of a Regular Meeting of October 6, 2011
  - B. Warrant list dated October 14, 2011 for \$47,785.03
- 6. BUSINESS**
  - A. Review and discuss preliminary Shorezone Alteration Permit Conditions of Approval, Marina Point Dredge Project
- 7. PUBLIC FORUM**

(The Board will receive comments from the public on items not on the agenda; no action is permitted on these items. Time set aside not to exceed 30 minutes total by all participants)
- 8. ANNOUNCEMENTS**
- 9. DIRECTOR COMMENTS**

**10. ADJOURNMENT**

**NEXT MEETING:** Open Session at 1:00 P.M.  
Thursday, November 3, 2011  
Big Bear Municipal Water District  
40524 Lakeview Drive, Big Bear Lake, CA

***MINUTES OF A REGULAR MEETING OF  
BIG BEAR MUNICIPAL WATER DISTRICT  
HELD ON THURSDAY, OCTOBER 6, 2011***

**CALL TO ORDER**

President Suhay called the Open Session to order at 1:00 PM. Those in attendance included Director Murphy, Director Fashempour, Director Eminger, Director Smith, District Counsel Wayne Lemieux (via Skype), General Manager Scott Heule, and Board Secretary Vicki Sheppard.

**REPORTS**

Mr. Heule introduced Phillip Flores, a new reporter working for the Grizzly. Mr. Heule reported that since the last meeting some staffing changes have formally been made. He announced the creation of one new position, Lake Operations Analyst, and introduced Tyler Cockrell who previously had the position of Launch Ramp Supervisor and Lake Patrol officer. He reported that Mr. Cockrell has already made huge strides in getting the RV Park reservation process in order. He added that he has also made significant improvements in recordkeeping and file updates for our private dock program. He explained that he will also be instrumental in fixing several flaws in our existing dock management operations and in assisting with Lake Patrol duties. Mr. Heule also announced that we have finally filled the vacant Lake Operations Supervisor position with Lake Patrol officer Adam Williams. He explained that Mr. Williams is completing his second season with the District and over the course of this past summer it became obvious to Mr. Stephenson and himself that he has earned the respect of the other officers and clearly would be an excellent addition to our full time staff. Mr. Heule commented that he and Mike Stephenson believe that with both Tyler Cockrell and Adam Williams on board the District is much better positioned to efficiently manage private docks, marina compensation, improve after-hours callouts, and beef up our early and late season Lake Patrol efforts. He welcomed both to their new positions. Mr. Heule reported that the highway bridge demolition is about half way done with the portion over Bay 2 and the decking on the catwalk. He added that during the original dam construction, metallic letters spelling out Eastwoods' and Garstins' names along with BVMW Co. 1910 – 11 were placed in the concrete of the catwalk. He commented that Garstin was the president of the water company at the time. He explained that Jim Weber took some photos of the lettering adding that he placed copies on the dais for the Directors to look at. Director Murphy asked if the District should do something special with this historical section. Mr. Heule stated that the Facilities Committee could discuss it. He reported that Caltrans has completed their design of the mitigation grouting program and sent it off to DSOD for preliminary review. He explained that they took most of DSOD's suggestions and revised and improved their program. He stated that, according to recent emails from Ray Stokes (Caltrans project supervisor), the project is essentially out of money. He added that, at this point, the District has no confirmation that any additional access to the catwalk or into Bay 7 will be constructed. He explained that Mike Stephenson will be meeting again with Ray Stokes when he returns next week to discuss these issues and get a clear picture of what we will be left when Caltrans finally leaves. Mr. Heule reported that he received information from the State Water Resources Control Board indicating the State, at the direction of the EPA and in response to the Clean Water Act, intends to create a Nutrient Policy for water bodies in the State. He added that the State could decide to allow each Regional Board to enforce some kind of numeric objective for water bodies in their jurisdictions or adopt regional objectives that would still rely on numeric

targets for nutrients in the water bodies. He commented that a scoping session hearing on this issue is scheduled in Sacramento for October 27<sup>th</sup> with written comments due November 10<sup>th</sup>. He stated that he cannot tell, based on his reading of the document, if the plan would alter the existing nutrient TMDL. He commented that it might create a new obligation for the District and other parties within the watershed. He reminded everyone that Tim Moore has stopped working for the TMDL Task Force. He explained that he indicated to Mr. Moore that the District would like his help on this issue but Mr. Moore did not commit to consulting on our behalf. He added that he has a scheduled conference call tomorrow. He stated that as he gets more information he will discuss it with the Watershed Committee and bring any actionable items to the full Board. Mr. Heule explained that Mike Stephenson is away at the CALMS Conference. He reported that Maintenance and Lake Patrol work is winding down as it always does this time of year. He explained that Maintenance has removed the bay markers and they are working to remove the 5 mph buoys from the lake for winter storage, a job that takes about a week to complete. He added that since the pace has slowed down, staff has been able to schedule filming and production of some new informational videos, one on the Lake rules and regulations and another on launching. He added that we are also discussing an informational video on private docks that hopefully would be very useful next spring. Mr. Heule commented that we got 2.7 inches of rainfall at the dam yesterday.

#### **APPROVAL OF CONSENT CALENDAR**

Upon a motion by Director Murphy, seconded by Director Eminger, the following consent items were unanimously approved:

- Minutes of a Regular Meeting of September 15, 2011
- Warrant list dated September 29, 2011 for \$104,828.18
- Approval of a Resolution of the Board of Directors of Big Bear Municipal Water District establishing Employee Compensation and amending Resolution No. 2011-04

#### **CONSIDER APPROVAL OF A WRITTEN STATEMENT OF DECISION AS PROPOSED IN THE MATTER OF THE APPEAL OF CRISANN CONROY**

Mr. Heule reported that in 2002, Crisann M. Conroy acquired improved property contiguous to Big Bear Lake. He explained that in 2005, she subdivided her property into two parcels, severing one from the lakefront. He added that she obtained a dock permit from the District for the lakefront property and then sold the lakefront property. He explained that the current owner of the lakefront parcel holds a District dock permit. Mr. Heule reported that acting through him (as the General Manager) the District, which owns the lake bottom, refused to issue a dock permit for the divided parcel which is no longer contiguous to the Lake. He explained that Ms. Conroy appealed the decision of the General Manager. He reported that the Board conducted an Administrative Hearing on June 16, 2011 adding that on September 15, 2011, during a closed session meeting, the Board of Directors deliberated this matter. He stated that after reconvening to open session the Board reported that they had approved a Written Statement of Decision in the matter of the appeal of Crisann Conroy. Mr. Heule explained that his decision to deny Conroy's request for a dock permit for the parcel without lake-frontage was sustained and the Board will now need to formally adopt the written decision.

Director Eminger moved approval of a written statement of decision as proposed in the matter of the appeal of Crisann Conroy. Director Murphy seconded the motion and it was unanimously approved.

**RECEIVE WATERSHED COMMITTEE REPORT ON THE TROUT POND AND  
PROVIDE DIRECTION TO STAFF**

Mr. Heule reported that the Watershed Committee recommended that the full Board discuss the various options and provide direction to staff. He explained that during a previous Watershed Committee meeting Staff was asked to:

1. Research potential listing/sales prices with realtors for the Trout Pond house
2. Speak with Reese Troublefield about Recreation and Park District interest in collaboration at the site, and
3. Research what costs there would be for creating a new parcel with just the house on it

Mr. Heule reported that he spoke/met with two realtors to discuss the sale of the house. Dan Bathurst, Exit Realty said the District could market the house for a little more than \$200,000. He also said that he had an investor that would probably be interested in buying the house, even though a subdivision recordation is in process. Christy Nelsen, Sunshine Realty, researched recent sales, listings and pending sales in the area and concluded it should be listed for \$199,900. She felt it could move pretty quickly at that price. Real estate sales commission fees and other sales expenses will likely be on the order of \$12,000 to \$18,000. He reported that he also secured a price for the subdivision process from Bob Carlisle at Transtech/MAPCO. He explained that the engineering fees to process a tentative tract map and final tract map would be \$8,000. He added that fees for the City permits/hearings etc would be about \$3,700 and a title report (parcel map guarantee) would be about \$500. He reported that Mr. Carlisle said that if the City had any special conditions that they wanted to add, the associated engineering fees would be billed on a time and materials basis adding that the process will take about one year to complete with the planning commission hearings and other meetings (the parcel map process will cost at least \$12,200). Mr. Heule reported that he also spoke to Reese Troublefield and briefly described the property suggesting that the District was interested in exploring potential partners for future development/use of the property. He explained that Mr. Troublefield advised that Recreation and Parks would be interested in further discussions and asked for a copy of the mapping of the site. He reported that Recreation and Park would be hiring a full time educator and use of the trout pond might fit in well with some ideas they had. He explained that it was further discovered that any remaining parcel after the house is sold will need a sewer connection (\$4,500) for restrooms, meeting space and secure and weather proof storage space. He added that any permits for new construction at the property will have to satisfy engineering calculations showing it will not make the flooding problem worse for adjacent properties. Mr. Heule explained that after discussing these factors staff thought the Board might like to discuss the possible sale of the house. He commented that Staff also thought that with a bit of interior remodeling a meeting room and men's and women's restrooms could be constructed at a reasonable cost. He reported that would result in plenty of secure storage and a facility that could almost immediately be put to use for a variety of public purposes and also some additional work could be done on the bait shack/ticket office to create a three sided open air classroom without too much effort. Mr. Heule explained that after hearing all of this information the Committee thought it would be best to discuss these matters in detail with the rest of the Board in order to provide clear direction to staff. District Counsel Wayne Lemieux stated that the District does not have to assume that they have to go through a subdivision process adding that this can be discussed later. Director Fashempour explained that the Committee looked at the expense of possibly involving the Flood Control District. Mr. Heule reported that additional studies would be required regarding the 100 year flood plane and the possibility of making a flooding problem worse. Director Eminger stated that there is still a lot of cleaning up to do so there is no big rush to make a decision on the house adding that we still need to discuss the various options. President Suhay asked if fish-raising is

still one on the table. Director Fashempour stated that is not being discussed today adding that we need to decide about the house and the bait shack asking for opinions on dividing and selling the house and re-configuring the shack/shed. President Suhay commented that if we don't know what we are going to do with the buildings (leave and remodel or tear down) we can't make a decision. Mr. Heule stated that one conclusion that was reached during the workshop some months ago was that the house should be sold, but the Committee now thinks we need to possibly revise this and ask the full Board. President Suhay stated that there are Flood Control issues. Mr. Heule stated that by not selling the house now the District's options remain open. Director Fashempour stated that we could re-configure (remodel) the house. Director Murphy stated that it is better not to sell the house at this time and see if values go up. President Suhay commented that we need to do something with the area to make it fit for public use. Director Smith stated that it is not a good time to sell the house and he questioned disclosure issues; bus loads of children arriving right next door to a private home. Director Eminger commented that when it was an operating trout pond there were lots of children there. Director Smith said that is true with the neighbors but not right at the house on the property. Director Smith added that he believes we should keep the house now (not put it up for sale) and look at options in the future. He commented that as far as tearing down the building, he sees \$50,000 in fees and permits before we would even take the building down adding that it might not be worth it. President Suhay stated that maybe we could use part of the house as a caretaker house and the other as a meeting room. Director Smith asked Mr. Lemieux about disclosure laws and a conflict if numerous children were right next door to the house. Mr. Lemieux stated that he is not greatly concerned and the District can make a general disclosure prior to sale. President Suhay asked if we will need a special use permit. Mr. Lemieux stated that he will go over it with Mr. Heule after the meeting.

Director Smith moved approval of not pursuing the subdivision or sale of the house at this time and to just continue the clean up the property and look at other options in the spring. Director Fashempour seconded the motion and it was unanimously approved.

## **PUBLIC FORUM**

No comments were made

## **ANNOUNCEMENTS**

Mr. Heule announced that Mr. Stephenson will be watching over the day-to-day issues while he is at the CSDA conference next week, Monday through Thursday. He added that he and his wife Jackie will be vacationing in Hawaii October 27<sup>th</sup> through November 5<sup>th</sup> so he will miss the Board meeting on the 3<sup>rd</sup>.

## **DIRECTOR COMMENTS**

Director Eminger thanked "Mother Nature" for the rain commenting that it should be beneficial during the fire season. He asked how the Troutfest tournament went. Mr. Heule responded that the weather was excellent for the event which attracted 743 anglers but only 3 vendors. He explained that there was a major backup of boaters trying to launch Saturday morning at 6am adding that Big Bear Marina staff did not arrive at the marina until 6. He reported that there were some problems but most participants seemed to have a good time. He added that hopefully next year the organizers will have a better handle on the necessary details and logistics of running the event. Director Eminger asked if Western Outdoor News was okay with it. Mr. Heule commented that they seemed satisfied adding that they learned some things from the experience. He explained that District staff did end up helping out more than anticipated.

**ADJOURNMENT**

There being no further business, the meeting was adjourned at 1:48 P.M.

**NEXT MEETING**

Open Session at 1:00 P.M.  
Thursday, October 20, 2011  
Big Bear Municipal Water District  
40524 Lakeview Drive, Big Bear Lake, CA

---

Vicki Sheppard  
Secretary to the Board  
Big Bear Municipal Water District

(SEAL)

**Big Bear Municipal Water District  
 Computer & Manual Check Register  
 Current and History Files, 09/30/11 to 10/11/11  
 Account 10010-00-001, Sessions 000000 to 002460**

<u>Check</u>	<u>Payment / Vendor Information</u>	<u>Ck Date</u>	<u>Prity</u>	<u>Invoice</u>	<u>Session</u>	<u>Reference</u>	<u>Amount</u>
<b>Checking Account: 10010-00-001</b>							
149732	AAUW / AMERICAN ASSOC OF UNIVERSITY WOMEN	10/10/11	2	10042011	002443	BRDRMDEPO	55.00
						<b>AAUW Subtotal :</b>	<b>55.00</b>
149733	ACWAHB / ACWA Health Benefits Authority (H)	10/10/11	2	11012011	002443	INSURANCE	20259.13
						<b>ACWAHB Subtotal :</b>	<b>20259.13</b>
149734	BMARIN / Big Bear Marina	10/10/11	2	10311154	002443	PETRO-BOAT	850.06
						<b>BMARIN Subtotal :</b>	<b>850.06</b>
149735		10/10/11	2	10311153	002443	PETRO-BOAT	495.22
						<b>BMARIN Subtotal :</b>	<b>495.22</b>
149736		10/10/11	2	10311155	002443	PETRO-BOAT	919.16
						<b>BMARIN Subtotal :</b>	<b>919.16</b>
149737		10/10/11	2	TRTFEST11	002443	SPENTDEPO	500.00
						<b>BMARIN Subtotal :</b>	<b>500.00</b>
149738	BURBAK / Burback's Auto Electric	10/10/11	2	714476	002443	WORKBOAT	140.08
						<b>BURBAK Subtotal :</b>	<b>140.08</b>
149739	BUTCHR / Butcher's Block & Building Materi	10/10/11	2	89987	002443	DAMMAINT	49.07
149739		10/10/11	2	91038	002443	SHOPMAINT	22.05
149739		10/10/11	2	91070	002443	PATROL	13.43
149739		10/10/11	2	91458	002443	FACILMAINT	150.33
149739		10/10/11	2	91688	002443	FACILMAINT	20.47
149739		10/10/11	2	91690	002443	WEIRMAINT	66.13
149739		10/10/11	2	92181	002443	WTRSHDSUPP	18.31
149739		10/10/11	2	92368	002443	PATROL	7.80
149739		10/10/11	2	92415-	002443	SHOPMAINT	23.08
149739		10/10/11	2	92429	002443	MARINAMAIN	48.27
149739		10/10/11	2	92802	002443	DAMMAINT	487.42
149739		10/10/11	2	93889	002443	SHOPMAINT	19.02
						<b>BUTCHR Subtotal :</b>	<b>925.38</b>
149740	BVELEC / Bear Valley Electric	10/10/11	2	09232011	002443	UTIL-RAMP	229.86
149740		10/10/11	2	09292011	002443	UTIL-RAMP	343.25
149740		10/10/11	2	09302011A	002443	UTIL-DAM	231.86
149740		10/10/11	2	09302011B	002443	UTIL-MAIN	12.56
149740		10/10/11	2	09302011C	002443	UTIL-AERAT	1560.93
149740		10/10/11	2	09302011D	002443	UTIL-DAM	12.56



Big Bear Municipal Water District  
 Computer & Manual Check Register  
 Current and History Files, 09/30/11 to 10/11/11  
 Account 10010-00-001, Sessions 000000 to 002460

Check	Payment / Vendor Information	Ck Date	Prty	Invoice	Session	Reference	Amount
						<b>BVELEC Subtotal :</b>	2391.02
149741	BVPRIN / Bear Valley Printing	10/10/11	2	81285	002443	OFFICSUPPL	161.63
						<b>BVPRIN Subtotal :</b>	161.63
149742	CBSOA / CA Boating Safety Officers Assoc.	10/10/11	2	2011	002443	MEMBERSHIP	25.00
						<b>CBSOA Subtotal :</b>	25.00
149743	CCONNE / CONNELLY PUMPING SERVICES	10/10/11	2	11194	002443	SSRELIEFS	360.00
149743		10/10/11	2	112010	002443	PORTABLES	290.00
149743		10/10/11	2	11207	002443	PORTABLES	255.01
149743		10/10/11	2	11208	002443	PORTABLES	290.00
149743		10/10/11	2	11209	002443	PORTABLES	220.00
						<b>CCONNE Subtotal :</b>	1415.01
149744	CHARTE / CHARTER COMMUNICATIONS	10/10/11	2	09162011	002443	PHONE-NET	274.99
						<b>CHARTE Subtotal :</b>	274.99
149745	CHEMPA / CHEM PAK PRODUCTS	10/10/11	2	74306	002443	RAMPSUPPL	67.67
						<b>CHEMPA Subtotal :</b>	67.67
149746	COMPVI / COMPUTER VILLAGE	10/10/11	2	122825	002443	PROFSVCS	150.00
149746		10/10/11	2	122867	002443		735.97
						<b>COMPVI Subtotal :</b>	885.97
149747	COMSER / ComSerCo	10/10/11	2	5MA502438	002443	RADSVCCONT	255.00
						<b>COMSER Subtotal :</b>	255.00
149748	CONNEY / Conney Safety Products	10/10/11	2	04007932	002443	JANITSUPP	89.99
						<b>CONNEY Subtotal :</b>	89.99
149749	DIRECTV / DIRECTV	10/10/11	2	1608121198	002443	UTIL-RV	157.49
						<b>DIRECTV Subtotal :</b>	157.49
149750	DWP / Department of Water and Power	10/10/11	2	09292011A	002443	UTIL-MAIN	160.95
149750		10/10/11	2	09292011B	002443	UTIL-MAIN	14.60
149750		10/10/11	2	09292011C	002443	UTIL-RAMP	260.81
149750		10/10/11	2	09292011D	002443	UTIL-MAIN	48.12
149750		10/10/11	2	09292011E	002443	UTIL-RAMP	19.47
149750		10/10/11	2	09292011F	002443	UTIL-TROUT	80.22
						<b>DWP Subtotal :</b>	584.17

**Big Bear Municipal Water District  
 Computer & Manual Check Register  
 Current and History Files, 09/30/11 to 10/11/11  
 Account 10010-00-001, Sessions 000000 to 002460**

Check	Payment / Vendor Information	Ck Date	Prty	Invoice	Session	Reference	Amount
149751	ETSPUW / Education & Training Services Pub	10/10/11	2	COCKRELL11	002443	EMPTRAININ	449.00
						ETSPUW Subtotal :	449.00
149752		10/10/11	2	WILLIAMS11	002443	EMPTRAININ	549.00
						ETSPUW Subtotal :	549.00
149754	FREDPR / Fred Pryor Seminars	10/10/11	2	12989394	002443	EMPTRAININ	249.00
						FREDPR Subtotal :	249.00
149755	GEI / GEI Consultants, Inc	10/10/11	2	504050	002443		2714.14
						GEI Subtotal :	2714.14
149756	GLOBLW / Global Water	10/10/11	2	130390	002443	WTRSHDMGMT	1021.47
						GLOBLW Subtotal :	1021.47
149757	HOLLOW / Holloway's Marina & RV Park	10/10/11	2	20470	002443	ELECTRBOAT	458.22
						HOLLOW Subtotal :	458.22
149758	IDEARC / SUPERMEDIA LLC	10/10/11	2	09192011	002443	EMAIL.OR	29.95
						IDEARC Subtotal :	29.95
149759	LEMIEU / LEMIEUX & O'NEILL	10/10/11	2	20024M-1	002443	LEGALSAL	74.63
						LEMIEU Subtotal :	74.63
149760		10/10/11	2	20022M-13	002443	LEGALCC	60.00
						LEMIEU Subtotal :	60.00
149761		10/10/11	2	20999M146	002443	LEGALRETAN	3500.00
						LEMIEU Subtotal :	3500.00
149762	LUDECK / Ludecke's Electric Service	10/10/11	2	6417	002443	DAMMAINT	641.25
						LUDECK Subtotal :	641.25
149763	MASTER / FIRST BANKCARD CENTER	10/10/11	2	0930114817	002443	MASTER505	635.00
149763		10/10/11	2	0930116888	002443	MASTER506	635.00
						MASTER Subtotal :	1270.00
149764	MCMSTR / McMaster-Carr Supply Co.	10/10/11	2	96285370	002443	SHOPMAINT	54.50
						MCMSTR Subtotal :	54.50
149765	MCOYBR / Mountain Water Company	10/10/11	2	19951	002443	UTIL-RAMPS	59.95
149765		10/10/11	2	20075	002443	UTIL-RAMP	125.00
						MCOYBR Subtotal :	184.95
149766	NAPA / McConnell Motor Parts	10/10/11	2	050808	002443	WKBOATS	14.54

**Big Bear Municipal Water District  
 Computer & Manual Check Register  
 Current and History Files, 09/30/11 to 10/11/11  
 Account 10010-00-001, Sessions 000000 to 002460**

Check	Payment / Vendor Information	Ck Date	Prity	Invoice	Session	Reference	Amount
	Inc.						
149766		10/10/11	2	051042	002443	ONROAD	65.82
149766		10/10/11	2	051387	002443	ONROAD	6.09
149766		10/10/11	2	051934	002443	RAMPMAINT	80.76
						<b>NAPA Subtotal :</b>	<b>167.21</b>
149767	PITNEY / Purchase Power	10/10/11	2	09192011	002443	POSTAGE	1130.13
						<b>PITNEY Subtotal :</b>	<b>1130.13</b>
149768	QUILL / Quill Corporation	10/10/11	2	5289592-	002443	OFFICSUPPL	3.28
149768		10/10/11	2	6925166	002443	OFFICSUPPL	11.99
149768		10/10/11	2	7008389	002443	OFFICSUPPL	41.69
						<b>QUILL Subtotal :</b>	<b>56.96</b>
149769	ROBERT / Robertson's	10/10/11	2	820016	002443	MARINAMAIN	77.58
						<b>ROBERT Subtotal :</b>	<b>77.58</b>
149770	ROCKHU / ROCKHURST UNIVERSITY	10/10/11	2	401190144	002443	EMPTRAININ	199.00
						<b>ROCKHU Subtotal :</b>	<b>199.00</b>
149771	ROTARY / Rotary Club of Big Bear Lake	10/10/11	2	09302011	002443	MEMBERSHIP	161.00
						<b>ROTARY Subtotal :</b>	<b>161.00</b>
149772	SMITHR / Smith Root Inc	10/10/11	2	33035	002443	ELECTRBOAT	527.23
						<b>SMITHR Subtotal :</b>	<b>527.23</b>
149773	SQUEEG / Squeegee Clean Window Service	10/10/11	2	09262011	002443	FACILMAINT	50.00
						<b>SQUEEG Subtotal :</b>	<b>50.00</b>
149774	STOFCA / State of California-Empl. Dev. Dp	10/10/11	2	2011-QTR3	002443		2609.99
						<b>STOFCA Subtotal :</b>	<b>2609.99</b>
149775	UPS / UPS	10/10/11	2	F33Y11401	002443	SHIPWATER	506.19
						<b>UPS Subtotal :</b>	<b>506.19</b>
149776	VERIZO / Verizon California	10/10/11	2	09252011	002443	PHONE-WS	30.60
149776		10/10/11	2	09282011	002443	PHONE-DAM	40.79
						<b>VERIZO Subtotal :</b>	<b>71.39</b>
149777	XEROX / Xerox Corporation	10/10/11	2	057618551	002443	COPIERLEAS	520.27
						<b>XEROX Subtotal :</b>	<b>520.27</b>
						<b>Total For Check Account: 10010-00-001</b>	<b>47785.03</b>

**BIG BEAR MUNICIPAL WATER DISTRICT  
REPORT TO BOARD OF DIRECTORS**

**MEETING DATE:** *October 20, 2011*

**AGENDA ITEM:** *6A*

**SUBJECT:**

**REVIEW AND DISCUSS PRELIMINARY SHOREZONE ALTERATION PERMIT  
CONDITIONS OF APPROVAL, MARINA POINT DREDGE PROJECT**

**RECOMMENDATION:**

The General Manager and Lake Improvement Committee (Directors Suhay & Smith) recommend the Board review and discuss the preliminary permit conditions and provide direction to Staff.

**DISCUSSION/FINDINGS:**

Marina Point Development Associates (applicant) submitted a shorezone alteration application on September 20, 2011. The proposed work generally includes dredging within and around the old Cluster Pines marina, opening the marina to the lake, and protecting exposed shoreline and jetty slopes from erosion. A draft project description and mapping associated with the permit application are attached. The California Environmental Quality Act (CEQA) lead agency for the Marina Point Development project, San Bernardino County, in a letter dated September 27, 2011 (attached) states in part "With the recordation of Tract 12217, the EIR and Final Development Plan for the Marina Point Project remain active. This project and all development plans (grading plans, building plans, etc.) shall be prepared and constructed in conformance with the originally approved EIR, Final Development Plan and the Conditions of Approval as approved on December 9, 1991." District legal counsel advises that the District, as a responsible agency, use the approved EIR and existing District practice to identify conditions of approval in response to the shorezone alteration application.

Conditions of approval have the general intent to document existing and as built bathymetry, define the most appropriate silt curtain alignment and depth, protect lake water quality, provide lake access during construction and accurately reflect public and private property ownership among others. The Committee proposes the following preliminary conditions be attached to the approval of a shorezone alteration permit that could be considered during the regularly scheduled Board meeting on November 17, 2011.

1. The applicant, Marina Point Development Associates, shall initiate and complete installation of jetty protection on the east jetty within 30 days of approval of the Shorezone Alteration Permit. If this cannot be accomplished, the applicant shall document the reasons for delays to the District.
2. The applicant shall submit current bathymetry mapping prior to initiating any dredging activities. This mapping shall be submitted to the District on paper and in a geo-referenced format compatible with the Districts' electronic mapping software for review and approval prior to initiating any dredging activities.
3. The applicant shall provide bathymetry mapping to document the as built conditions of all new dredge/fill areas extending a minimum of 200 feet from the nearest point above the OHWM. This information shall be submitted to the District on paper and in a geo-referenced format compatible with the Districts' electronic mapping software within 30 days of completing any dredging activities for District review and approval.

4. The applicant shall not initiate any dredging or haul road construction prior to April 15, 2012.
5. The applicant shall install silt curtains of sufficient length to extend at least two feet deeper than the water depth along their proposed alignment. Prior to dredging the owner shall document this condition has been met to the satisfaction of the District.
6. The applicant shall submit a Stormwater Pollution Prevention Plan (SWPPP) to the District for review and approval prior to initiating any disturbance of the lakebed below the OHWM. At a minimum this SWPPP shall identify all best management practices that will be implemented for all activities that directly affect lakebed below the ordinary OHWM and those construction activities that could indirectly affect the quality of water in the Lake. The SWPPP shall also include measures to address the accidental release of any hazardous or toxic material (such as petroleum product spills) that could enter into the Lake. The applicant shall demonstrate that all materials required to implement the SWPPP are in place before initiating construction activities that could degrade water quality of the Lake.
7. The applicant shall submit copies of the following current applicable permits prior to commencement of work at the site
  - a. California Department of Fish and Game Section 1601-1603 permit, and the
  - b. US Army Corps of Engineers Section 404 permit, and the
  - c. Regional Water Quality Control Board permit and the current BMP's imposed by that permit.
8. The applicant shall survey, file and record with the County of San Bernardino property lines on top of the marina jetties that accurately reflect actual post project private and public boundaries.
9. The applicant shall provide accommodation for the owners of Docks 727, 728 and 729 (APN's 0304-151-34, -47, and -48) to access the lake during the course of construction.
10. Secure necessary permits from the appropriate agencies to allow future maintenance dredging within all dredged areas identified in the current shorezone alteration application.

In addition to any conditions the District might place on the dredge project Order No. 92-3 issued in February 1992 by the Santa Ana Regional Water Quality Control Board establishes waste discharge requirements and a monitoring and reporting program the applicant will have to satisfy during the construction. A copy of the order is attached. While the Waste Discharge Permit remains valid today the applicant will have to perform the dredge project under the most current Best Management Practices defined by the Regional Water Quality Control Board.

***OTHER AGENCY INVOLVEMENT:*** None

***FINANCING:*** None

Submitted by: Scott Heule, General Manager

**-DRAFT-  
Marina Point  
Project Description  
10-17-2011 (attachments not included)**

Introduction

The Marina Point Development Associates (MPDA) property consists of a 13.51-acre site located along State Highway 38 near the town of Fawnskin on the north shore of Big Bear Lake and at the northeast end of Grout Bay. The entire shoreline and marina jetties of the Marina Point Property are part of a 4.5-acre historic landfill constructed in the late-1960s that created the existing marina. At that time the lake bottom surrounding the landfill in the marina was disturbed by dredge and fill operations. The original marina construction included rip-rap protection along all of the shoreline and both sides of the jetty slopes.

In 1983 the County of San Bernardino authorized the development of a condominium project to be located on the 12 acres adjacent to the marina. In 1989, the tract map expired and MPDA was required to submit a new TM and Planned Development Permit Application. The County conducted a new EIR as the lead agency in accordance with the California Environmental Quality Act (CEQA) which it adopted and certified in December 1991 after consultation with relevant agencies, including the District. The attached letter from San Bernardino County verifies that the Marina Point Planned Development County permits remains "active." Refer to Appendix 1. The implementation of this project has been on hold for the past 28 years for a variety of reasons, including extensive litigation and the requirement to obtain regulatory permits from a number of agencies, including the Big Bear Municipal Water District (District). The project developer, MPDA, has submitted a Shorezone Alteration Application to the District (September 20, 2011) that will be the subject of this environmental evaluation for compliance with the CEQA. A copy of the application is provided as Appendix 2 to this document.

Over the intervening period since approval of the Marina Point Project in 1983, the developer has carried out improvements to the existing marina. Shore-zone improvements were carried out in the 1990's and 2000's in accordance with a 1993 Shorezone Alteration Permit. The current permit application is intended to address additional work that needs to be completed at the marina, in particular activities that are needed to stabilize the marina levees; complete dredge activities; and control runoff from North Shore Drive (State Highway 38). In the applicant's own words the project is summarized as follows: *"The remaining dredging work is limited to: (i) removal of silt within the marina; (ii) 200 linear feet of the partially dredged lake bottom along the west shoreline to connect the existing dredged areas to improve lake circulation for water quality and boating safety during lower lake levels and; (iii) repair of the east shoreline around the Caltrans drainage pipe. Upon completion of the dredging and repair work, all of the shoreline will be protected with rock or slopes will be graded flatter than 3:1.* A more detailed description of the activities that would be permitted if the Shorezone Alternation Application is approved by the District is provided below.

Project Location

According to the current Shorezone Alteration Application (Appendix 2) the total acreage of the lake bottom to be disturbed by the project encompasses approximately 8.31 acres located on the north shore of Big Bear Lake. The project site address is 39505 North Shore Drive, Fawnskin, CA 92315, and the site encompasses the following Assessor Parcel Numbers

(APNs) 034-082-15, 17, 18, 20 and 21. Figure 1 shows the regional location of the project site and Figure 2 the area location on the USGS – Fawnskin Quadrangle, 7.5 Minute Series Topographic Map. Figure 3 shows the proposed Lake Enhancement Plan submitted by the Applicant. Figure 4 is a Google Aerial Photograph of the site and immediate surrounding area.

### Project Characteristics and Activities

The applicant's Shorezone Alteration Application consists of construction activities to complete erosion control features at the existing marina and modify the marina interior (dredging) and areas immediately adjacent to the exterior levees of the marina. This application does not include any requests for future marina operating conditions. Future operations would be addressed in a future permit application that would be evaluated on its own merits at the time it is submitted to the District. Thus, the only activities under consideration by the District at this time consist of construction activities to complete the marina's broad physical features while restoring erosion damage from the past several years and finally armoring the marina to minimize future erosion. As noted above, Figure 3 shows the proposed construction plans and Figures 4 through 8 show the cross-sectional changes in the site topography (aboveground landforms) and bathymetry (lake bottom topography).

The following construction activities would be implemented if the applicant's Shorezone Alteration Application is approved by the District.

1. Complete the shoreline protection along the east side of the Marina Point Property by undertaking the following actions: (i) install a 190-foot temporary, 15-foot wide haul road along the top of the proposed slopes on the east side of the drainage as depicted on Sheet 1 of 6, which is to be removed upon completion of the work; (ii) replace and extend the existing undersized 24-inch Caltrans pipe with a 48-inch pipe; (iii) replace the temporary quarry waste and check dam placed in February 2005 with a rip-rap energy dissipater at the 48-inch pipe outlet; (iv) grade the west bank and the east bank of the drainage leading to Big Bear Lake to create a variable 2:1 to 5:1 slope along the property line to repair existing erosion along the banks. This work would dredge 640 cubic yards (cy) of sediment and require 2,300 cy of fill to repair the slopes. This work will impact 1.05 acres below the ordinary high water mark (OHWM) of Big Bear Lake that were previously impacted under the Army Corps of Engineers (ACOE) 2005 Regional General Permit (RGP).

It is estimated that approximately 200 cy of soil will be required to install the proposed haul road. The applicant proposes to obtain this material from the upland stockpile of prior dredged material. The purpose of the temporary haul road is to provide access to transport material to repair the erosion and protect the shoreline slope on the east side of the Caltrans drainage.

The highway itself will be raised by approximately three feet in accordance with Caltrans approved design plans. The 48-inch culvert is proposed to be a corrugated metal pipe (CMP). The applicant indicates that no new rip-rap will be installed for energy dissipation because this facility can be constructed with the existing rock material placed under the prior work authorized in the 2005 RGP. The new culvert will comply with Caltrans design standards and no treatment of stormwater discharged through this CMP is proposed.

2. Dredge the sediment from the inside of the existing marina to a depth of 6,725 MSL with bottom dimensions of 260 by 400 feet. This dredge would remove approximately 22,765 cy of sediment. The 4,925 cy of material previously used to temporarily close the south side of the marina for use as a temporary desiltation basin during the ACOE 2003 ICMO will be removed when all other items of work are completed to reopen the marina to Big Bear Lake. This work includes removal of the rip-rap and quarry waste placed at the marina opening jetties and placing 3,270 cy of fill below the OHWM by outside of the jetties for temporary protection. This work also requires 3,270 cy of fill below the OHWM for the marina opening. All four sides of the inside of the marina jetty are to be finished to the existing configuration with 2:1 slopes. The slopes on the inside of the marina jetty are to be re-protected from erosion by placing 2,630 cy of quarry waste (8-inches minus) rock on all slopes and 910 cy of rip-rap at the south entrance. This repair and maintenance work will impact a total of 4.80 acres below the OHWM of Big Bear Lake. This includes 2.32 acres of previously impacted area and 2.48 acres of new impacts below the OHWM of Big Bear Lake since the original creation of landfill and marina.

According to the applicant the 22,500 cy of dredged material under this action will be deposited on the upland site. Drainage from the stockpiled dredged material will convey dewatering runoff to two existing desiltation basins adjacent to the marina. The applicant indicates that the dredged material will remain on the upland portion of the property and is proposed to be used as part of the site grading.

The proposed 3,270 cy of fill below the OHWM will be obtained from the previously dredged and dried material on the upland portion of the project site. According to the applicant the rock for slope erosion protection will be delivered to the site by the contractor under the existing approved County grading plan and is likely to be on the project site prior to initiation of construction under the District's Shorezone Alteration Application.

According to the applicant there are no totally new areas that will actually be impacted by the repairs. The entire area was previously disturbed when the landfill was created and during the 1981 repairs. The term "new" refers only to areas where the applicant has not worked since the 1991 Shorezone alteration plans were approved (?), specifically the lakebed within the existing marina. The applicant indicates that the effect of working within this expanded area will be the removal of the aquatic bed of noxious weeds within the area and the repair and re-protection of the slopes

3. Complete the balance of the exterior sides of the marina jetties. The marina jetties have been partially armored with a combination of two feet of rip-rap (12-inches plus) over one foot of quarry waste (8-inches minus) material in accordance with the ACOE ICMOs. The project proposes to repair current erosion and complete the slope protection by the placement of rip-rap and quarry waste from the top of the existing rip-rap to the top of the slopes at elevation  $\pm 6,744.5$  MSL. This quantity of slope protection fill is approximately 350 linear feet along the east side of the east jetty with a combination of two feet of rip-rap (12-inches plus) over one foot of quarry waste (8-inches minus). The work consists of the repair of current erosion and placement of approximately 830 cubic yards of rip-rap. This work will impact 0.26 acres of previously impacted area below the OHWM of Big Bear Lake.

According to the applicant the rock for slope erosion protection will be delivered to the site by the contractor under the existing approved County grading plan and is likely to be



on the project site prior to initiation of construction under the District's Shorezone Alteration Permit. Erosion repair will consist of installing quarry waste on the slope with rip-rap placed on the top of this material.

4. Complete a channel adjacent to the west shoreline of the property by continuing the minimum 50-foot bottom width channel from the end of the existing dredged channel (Coletta dredge) by the west jetty, then north along the shoreline to connect to an existing channel at the northwest end of the basin constructed in July 2003 and February 2005. This work will remove sediment from the lake-bottom and provide circulation of lake water for better water quality and boating safety at lower lake levels, as depicted on Sheet 1 of 6. This area will be dredged from a depth of 6,725 MSL at the south end to 6,730 MSL with an undulating bottom for shallow water fish habitat. Portions of the channel will be dredged to 5:1 side slopes for erosion protection. This dredge will remove approximately 3,240 cy of material below the OHWM.

To complete the shoreline protection along the western side of the property, the proposal is a combination of graduated slope and rip-rap as depicted on cross-sections C and E on Figures 6 and 8. The proposal would include 400 linear feet of rip-rap slope protection on slopes ranging from 2:1 to 3:1; create a variable slope from 3:1 to 12:1 for 300 linear feet; and a 12:1 slope for 100 linear feet. The work requires 5,420 cy of fill below the OHWM. Along the west side where slopes vary from 2:1 to 3:1, slope protection similar to the protection on the exterior of the jetties will be required. This includes 211 cubic yards of quarry waste and 423 cy of rip-rap placed below the OHWM. A 190-foot portion of an existing 15-foot wide haul road will be stabilized along the top of the proposed slopes below the OHWM, and a temporary 24-inch drain pipe will be installed. The road and pipe will be removed upon completion of the work. The location of the haul road is depicted on Figure 3. This work will impact a total of 2.07 acres below the OHWM of Big Bear Lake. This includes 1.81 acres of previously impacted area and 0.26 acres of new impacts below the OHWM of Big Bear Lake.

5. The applicant provided the following general construction scenario assuming all permits are in hand. All of the construction activities outlined above, except the installation of the CMP within the road right-of-way, would be implemented at one time, i.e., there would not be separate construction activities. Construction on the marina improvements would begin around April 15, 2012 when the site becomes dry enough to support construction activities. The CMP would be installed within the State Highway sometime next year, but a specific date has not yet been authorized by Caltrans. The equipment listed by the applicant to accomplish the above construction consists of a hydraulic dredge, backhoe, bulldozer, and dump truck.





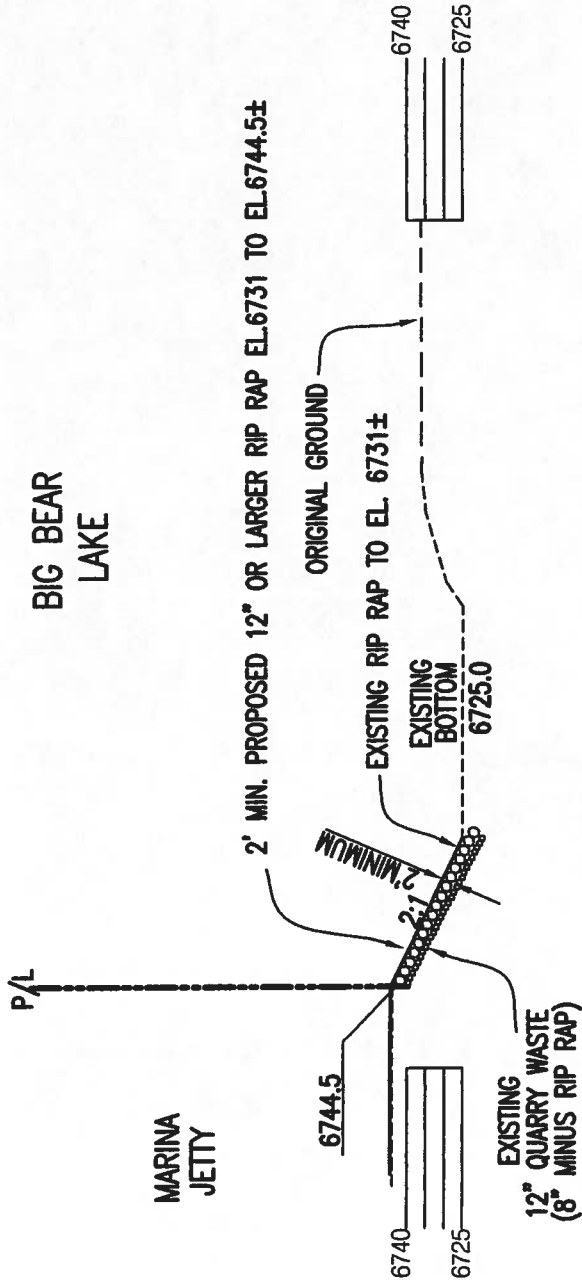

BIG BEAR LAKE

MARINA JETTY

**SECTION A-A**

EAST SIDE SECTION

SCALE : 1" = 50'

NOTE  
BIG BEAR LAKE OHWM = 6743.2

JOB NO. 843E  
DATE: 8/19/11  
SHEET 2 OF 6

LAKE ENHANCEMENT PLAN  
SHORELINE PROTECTION

SITE DESIGN ASSOCIATES, INC.  
1016 BROADWAY STE "A" EL CAJON, CALIFORNIA 92021  
(619) 442-8467 FAX (619) 442-8417  
DWG: 843E Marina Point Shoreline Protection 2011.dwg



**MARINA POINT**

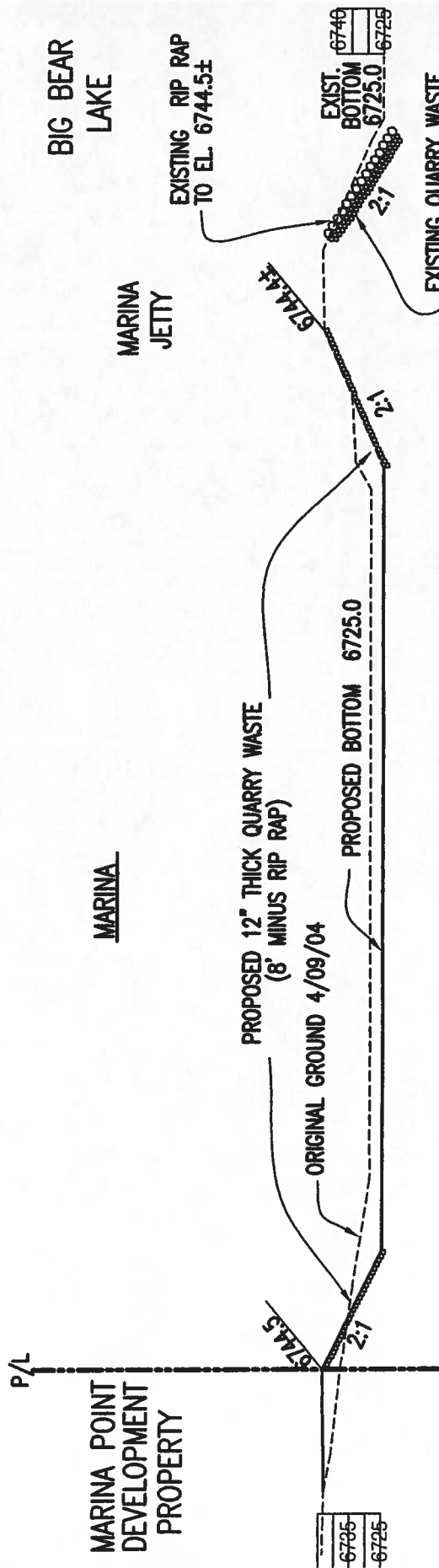

# SECTION B-B

MARINA SECTION

NOTE  
 BIG BEAR LAKE OHWM = 6743.2  
 SCALE : 1" = 50'

	SITE DESIGN ASSOCIATES, INC. 1016 BROADWAY STE "A" EL CAJON, CALIFORNIA 92021 (619) 442-8467 FAX (619) 442-8417 <small>DESIGN: BASE Marine Erosion Study - 03E 2011.dwg</small>	LAKE ENHANCEMENT PLAN SHORELINE PROTECTION	JOB NO. 843E DATE: 8/19/11 SHEET 3 OF 6
	<h2>MARINA POINT</h2>		

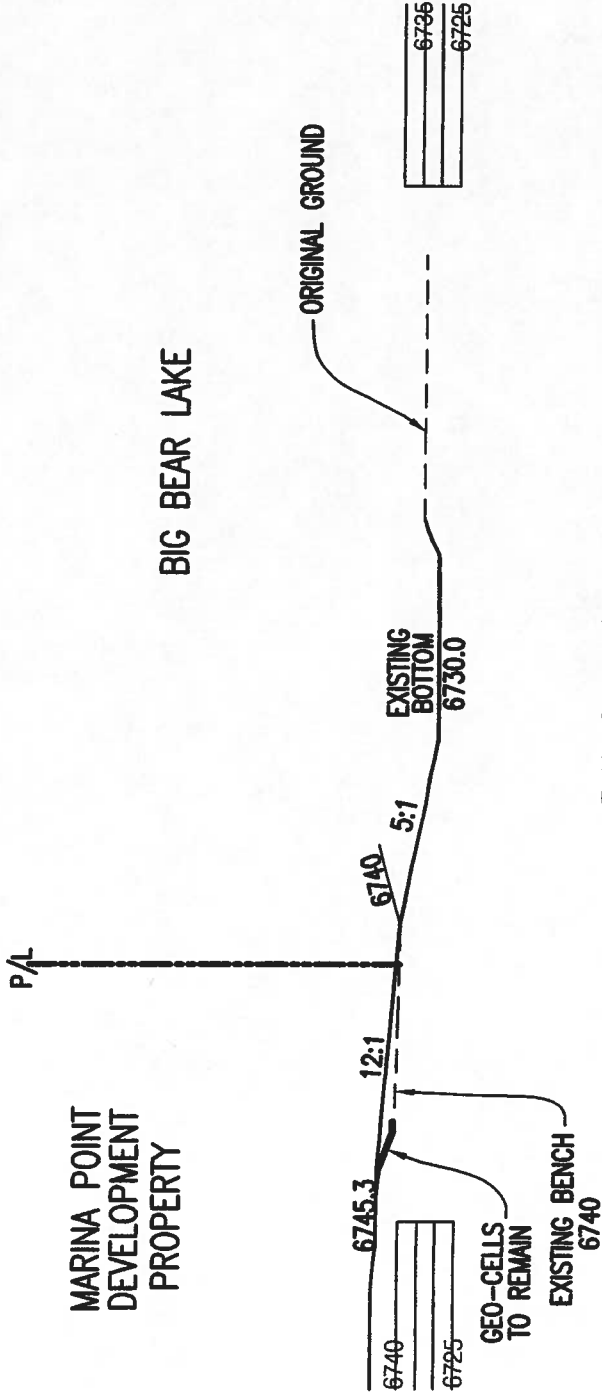

**SECTION C - C**  
WEST SIDE SECTION

SCALE : 1" = 50'

NOTE  
BIG BEAR LAKE OHWM = 6743.2

**SITE DESIGN ASSOCIATES, INC.**  
1016 BROADWAY, STE 'A' EL CAJON, CALIFORNIA 92021  
(619) 442-8467  
FAX (619) 442-8417  
DWG: 843E Marina Point\_Shrd-03E.dwg

LAKE ENHANCEMENT PLAN  
SHORELINE PROTECTION

**MARINA POINT**

JOB NO. 843E  
DATE: 8/19/11  
SHEET 4 OF 6

MARINA POINT  
DEVELOPMENT  
PROPERTY

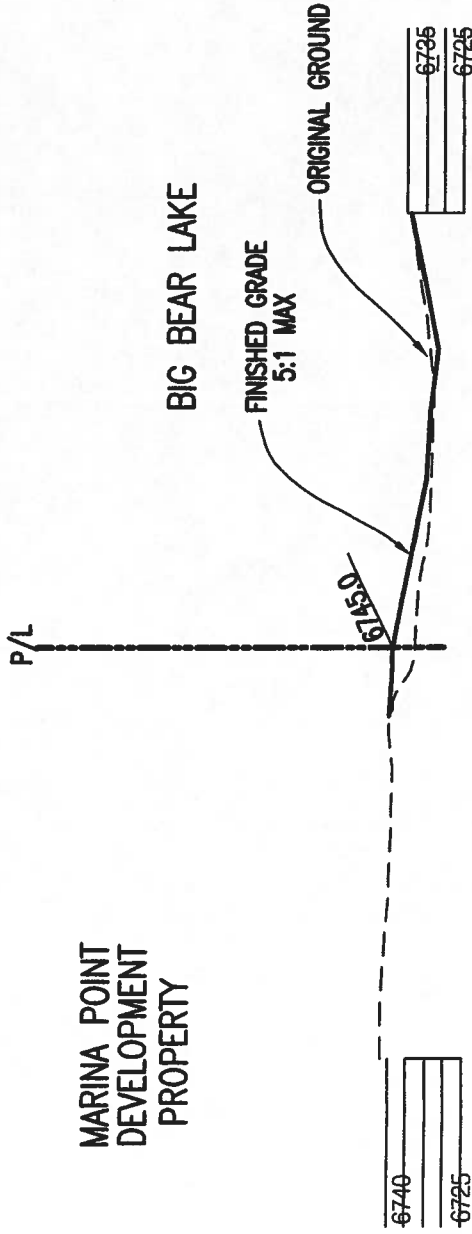

**SECTION D-D**  
EAST SIDE SECTION

NOTE  
BIG BEAR LAKE OHWM = 6743.2

SCALE : 1" = 50'



SITE DESIGN ASSOCIATES, INC.  
1016 BROADWAY STE "A" EL CAJON, CALIFORNIA 92021  
(619) 442-8467 FAX (619) 442-8417  
DWG: 843E Marina Point Shoreline Protection 2011.dwg

LAKE ENHANCEMENT PLAN  
SHORELINE PROTECTION

**MARINA POINT**

JOB NO. 843E  
DATE: 8/19/11  
SHEET 5 OF 6

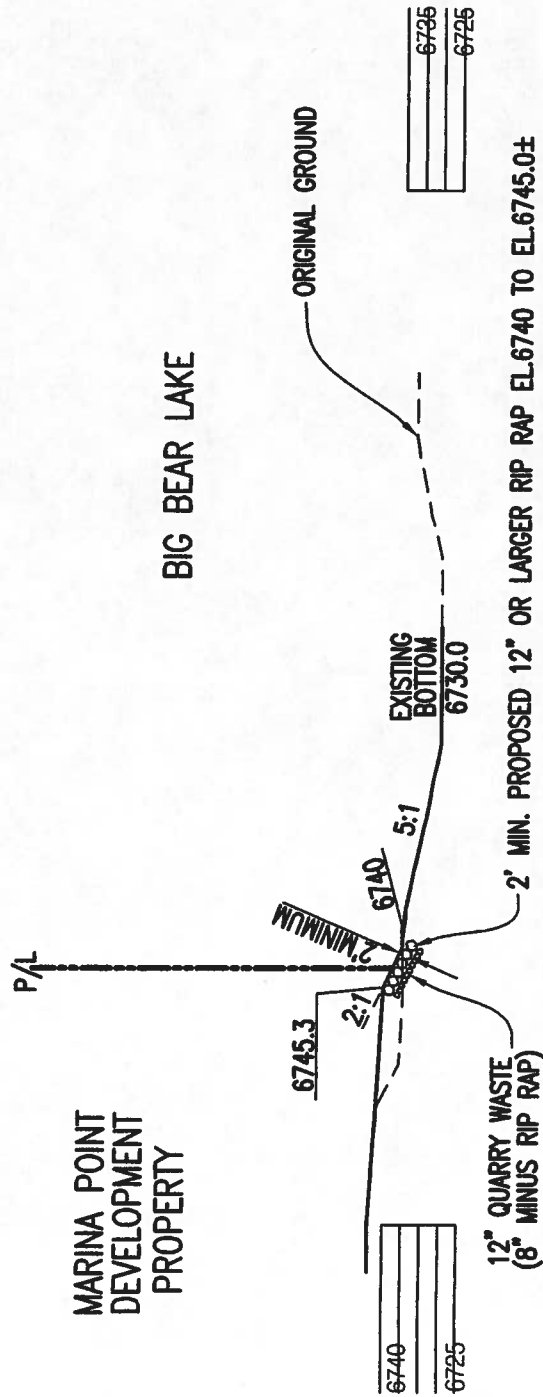

MARINA POINT  
DEVELOPMENT  
PROPERTY

BIG BEAR LAKE

ORIGINAL GROUND

6740
6725

12" QUARRY WASTE  
(8" MINUS RIP RAP)

EXISTING  
BOTTOM  
6730.0

6735
6725

2' MIN. PROPOSED 12" OR LARGER RIP RAP EL.6740 TO EL.6745.0±

# SECTION E-E

WEST SIDE SECTION

NOTE  
BIG BEAR LAKE OHWM = 6743.2

SCALE : 1" = 50'



SITE DESIGN ASSOCIATES, INC.  
1016 BROADWAY STE "A" EL CAJON, CALIFORNIA 92021  
(619) 442-8467 FAX (619) 442-8417  
DWG. BASE NUMBER: P002-2011.dwg

LAKE ENHANCEMENT PLAN  
SHORELINE PROTECTION

# MARINA POINT

JOB NO. 843E  
DATE: 8/19/11  
SHEET 6 OF 6



# LAND USE SERVICES DEPARTMENT



COUNTY OF SAN BERNARDINO

ADMINISTRATIVE OFFICE  
385 North Arrowhead Avenue • San Bernardino, CA 92415-0187  
(909) 387-4141 Fax (909) 387-3223  
<http://www.sbcounty.gov/landuseservices>

CHRISTINE KELLY  
Director

September 27, 2011

Irving Okovita  
Okon Development Co.  
P.O. Box 577  
Del Mar, CA 92410

**SUBJECT: MARINA POINT PLANNED DEVELOPMENT – STATUS OF ENVIRONMENTAL IMPACT REPORT AND FINAL DEVELOPMENT PLAN, BIG BEAR/3<sup>RD</sup> SUPERVISORIAL DISTRICT, P201000499.**

Dear Mr. Okovita,

This letter is in response to your request for the record concerning the Environmental Impact Report (EIR) and Final Development Plan for the Marina Point Project. On December 9, 1991, the County Board of Supervisors approved the EIR, Tentative Tract 12217, the Preliminary Development Plan and Final Development Plan for the Marina Point Project. Tract 12217 was subsequently recorded on December 21, 2000.

With the recordation of Tract 12217, the EIR and Final Development Plan for the Marina Point Project remain active. This project and all development plans (grading plans, building plans, etc.) shall be prepared and constructed in conformance with the originally approved EIR, Final Development Plan and the Conditions of Approval as approved on December 9, 1991. As the developer you are responsible to ascertain and comply with all laws, ordinances, regulations and any other requirements of Federal, State, County and Local agencies as are applicable to the development and operation of the approved land use and project site.

Sincerely,

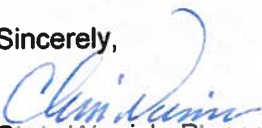
  
Chris Warrick, Planner  
County Planning Division

cc: Dena Smith, Deputy Executive Officer  
Christine Kelly, Director of Land Use Services  
Bobby Lewis, Planning Director  
Bart Brizzee, County Counsel  
Ken Discenza Site-Design Associates

California Regional Water Quality Control Board  
Santa Ana Region

Order No. 92-3

Waste Discharge Requirements  
for  
Marina Point Development Associates  
Big Bear Lake, Shoreline Dredging  
Fawnskin  
San Bernardino County

The California Regional Water Quality Control Board, Santa Ana Region (hereinafter Board), finds that:

1. On September 3, 1991, Marina Point Development Associates (hereinafter discharger) submitted a complete Report of Waste Discharge for waste discharge requirements for the discharge of wastes from a dredging operation.
2. The project site is located on the northeast shore of Grout Bay, North Shore Drive Fawnskin area of San Bernardino County. The location of this site is shown in Attachment "A" which is hereby made a part of this order.
3. The discharger is proposing to dredge along the shoreline of the Big Bear Lake. The project consists of removal of approximately 40,000 cubic yards of material from the northeast shore of Grout Bay, Big Bear Lake.
4. The areas to be dredged are shown on Attachment "B". These include approximately 1 acre east of the existing marina, approximately 3.4 acres within the existing marina at its northern end, and approximately 10.5 acres west of the existing marina. The depth of the dredging will vary generally from approximately 1.5 feet to a maximum of approximately 6 feet; within most of the existing marina the depth of dredging will be less than 3 feet.
5. Prior to dredging, silt curtains will be deployed within the three areas to be dredged to contain suspended particulates and silt. The dredged material will be stockpiled onsite. Tailwater from the stockpile will be run into a sedimentation basin and thence into the marina. The existing marina will be used as a second sedimentation basin allowing further containment and settling of suspended solids prior to mixing with lake water.

6. A water Quality Control Plan was adopted by the Board on May 13, 1983. This Plan contains water quality objectives and beneficial uses of waters in the Santa Ana Region. A Basin Plan amendment revising the table of beneficial uses was adopted by the Board on July 14, 1989.
7. The tailwater will be discharged to Big Bear Lake. The beneficial uses of Big Bear Lake include:
  - a. Municipal and domestic supply,
  - b. Agricultural supply,
  - c. Groundwater recharge,
  - d. Water contact recreation,
  - e. Non-contact water recreation,
  - f. Warm freshwater habitat,
  - g. Cold freshwater habitat, and
  - h. Wildlife habitat.
8. The requirements contained in this order are necessary to implement the Water Quality Control Plan.
9. The final Environmental Impact Report for the proposed project was first completed on February 8, 1983, then recirculated in September 1991. On December 9, 1991, it was certified by the San Bernardino County Board of Supervisors. Regional Board staff has reviewed the report and has found that the discharge will not have any significant adverse impact upon the quality of waters of the area if the requirements contained in this order are complied with.
10. The Board has notified the discharger and other interested agencies and persons of its intent to prescribe waste discharge requirements for the discharge and has provided them with an opportunity for public hearing and opportunity to submit their written views and recommendations.
12. The Board, in a public hearing, heard and considered all comments pertaining to the discharge.

IT IS HEREBY ORDERED that the discharger shall comply with the following:

A. Discharge Specifications

1. The discharge of tailwater containing suspended solids in excess of 50 mg/l to Big Bear Lake is prohibited.
2. Neither the dredging nor the discharge of dredge spoils shall cause a nuisance or pollution as defined in Section 13050 of the California Water Code.
3. The discharge of any substances in concentrations toxic to human, animal, plant or aquatic life is prohibited.
4. The discharge of wastes to property not owned or controlled by the discharger is prohibited.
5. Construction or removal of the dike to block the marina shall not cause the turbidity in the lake 100 feet outside the silt curtain to be increased by more than twenty (20) percent.
6. Excavation activities shall not cause the turbidity in the lake 100 feet outside the diked project area to be increased by more than twenty (20) percent.
7. Construction or removal of the dike to block the marina shall not cause suspended solids in the lake 100 feet outside of the silt curtain to exceed 50 mg/l.
8. The dredging activities, construction activities and/or discharge of tailwater shall not cause the dissolved oxygen in the receiving waters to be depressed below 5.0 mg/l. When natural dissolved oxygen concentrations are less than 5.0 mg/l, the discharge shall not cause a further depression.

B. Provisions

1. The discharger shall comply with the Monitoring and Reporting Program No. 92-3.
2. Compliance with Discharge Specification A.1., 5., 6., 7., & 8 shall be based on the results of each individual sample.
3. Prior to dredging, silt curtains shall be deployed within the three areas to be dredged to contain suspended particulates and silt.

4. In the event of any change in control or ownership of land or waste discharge facilities currently owned or controlled by the discharger, the discharger shall notify the succeeding owner or operator of the existence of this order by letter, a copy of which shall be forwarded to this Board.
5. The discharger shall report any discharge of waste that may endanger health or the environment. Such information shall be provided to the Executive Officer (714-782-4130) and the Office of Emergency Services (800-852-7550), if appropriate, as soon as the discharger becomes aware of the circumstances. A written report shall be submitted within five (5) days of the time the discharger becomes aware of the circumstances and shall contain a description of the discharge and its cause; the period of discharge, including exact dates and times and, if the discharge has not been corrected, the anticipated time to reduce, eliminate, and prevent reoccurrence of the discharge.
6. The discharger shall report promptly to the Board any material change in the character, location, and/or volume of the discharge.
7. The discharger shall permit Board staff:
  - a. Entry upon premises in which an effluent source is located, or in which any required records are kept;
  - b. Access to copy any records required to be kept under terms and conditions of this order;
  - c. Inspection of monitoring equipment or records; and
  - d. Sampling of any discharge.

I Gerard J. Thibeault, Executive Officer, do hereby certify that the foregoing is a full, true, and correct copy of an order adopted by the California Regional Water Quality Control Board, Santa Ana Region, on February 14, 1992.

  
\_\_\_\_\_  
Gerard J. Thibeault  
Executive Officer

California Regional Water Quality Control Board  
Santa Ana Region

Monitoring and Reporting Program No. 92-3  
for  
Marina Point Development Associates  
Big Bear Lake, Shoreline Dredging  
Fawnskin  
San Bernardino County

A. General Monitoring Requirements

This monitoring program shall be implemented with the initiation of the dredging project. A sampling station shall be established for each project area where representative sample of the discharge can be obtained. The following shall constitute the monitoring program.

1. One grab sample of tailwater leaving the sedimentation basin shall be collected on a weekly basis. The sample shall be analyzed for suspended solids.
2. The volume of dredged material excavated shall be estimated and recorded on a weekly basis.
3. A background sampling station shall be designated in Big Bear Lake to represent the natural conditions of the Lake. Additional sampling stations shall be established in the lake 100 feet from the silt curtain areas. These locations shall be reported to the Board once they are established.

Weekly, at each of the established sample stations, samples shall be collected at a depth of three feet below the water surface. If conditions at the time of sampling do not allow for sampling at this depth at the designated locations, then another appropriate location shall be used to obtain the necessary samples. A statement regarding the use of alternate sampling locations should be included in the report. The samples so collected shall be analyzed for suspended solids, turbidity and dissolved oxygen.

4. Unless otherwise noted, all sampling, sample preservation, and analysis shall be performed in accordance with the latest edition of "Guideline Establishing Test Procedures for Analysis of Pollutant" promulgated by the United States Environmental Protection Agency (40 CFR 136).

B. Reporting

1. The results of the above analyses shall be reported to the Board within 24 hours of finding any discharge that is in violation of the discharge specifications.
2. A monitoring report shall be submitted by the 30th day of each month and shall include the following for the previous month:
  - a. A copy of the chemical analyses.
  - b. A record of the amount in cubic yards of material dredged during the week and the cumulative amount todate, and
  - c. A summary of the month's activities.
3. If no material is dredged during a given period, a report to that effect shall be submitted in lieu of a monitoring report.
4. All reports shall be arranged in a tabular format to clearly show compliance or noncompliance with each discharge specification.
5. For every item where the requirements are not met, the discharger shall submit a statement of the actions undertaken or proposed which will bring the discharge into full compliance with requirements at the earliest time and submit a timetable for correction.

All reports shall be signed by a responsible officer or duly authorized representative of the discharger and shall be submitted under penalty of perjury.

Ordered by

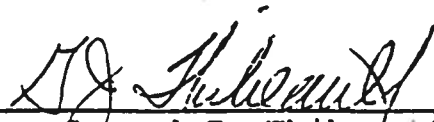

Gerard J. Thibeault  
Executive Officer

February 14, 1992

SCALE  
200'

1" = 200'

Approximate

400

3:1 Slope

NORTH

Dredged material  
= 10,000 c.y.

Dredged material  
stockpile  
= 31,000 c.y.

5:1 Slope

4:1 Slope

PVC pipe

Dredged material  
stockpile  
= 10,000 c.y.

Proposed bottom  
elevations: 6722.0 masl







Dredged material  
= 28,000 c.y.

2:1 Slope

2:1 Slope

Dredged material  
= 2000 c.y.

LEGEND

-  Sheet metal pile wall
-  Site boundary
-  Rip rap
-  Silt curtain
-  PVC pipe
-  Direction of flow

Site plan adapted from sheet titled "Stockpile Grading Plan" by Site Design Associates, Inc. Dated 7-25-91

SITE PLAN

Marina Point

FIGURE

2



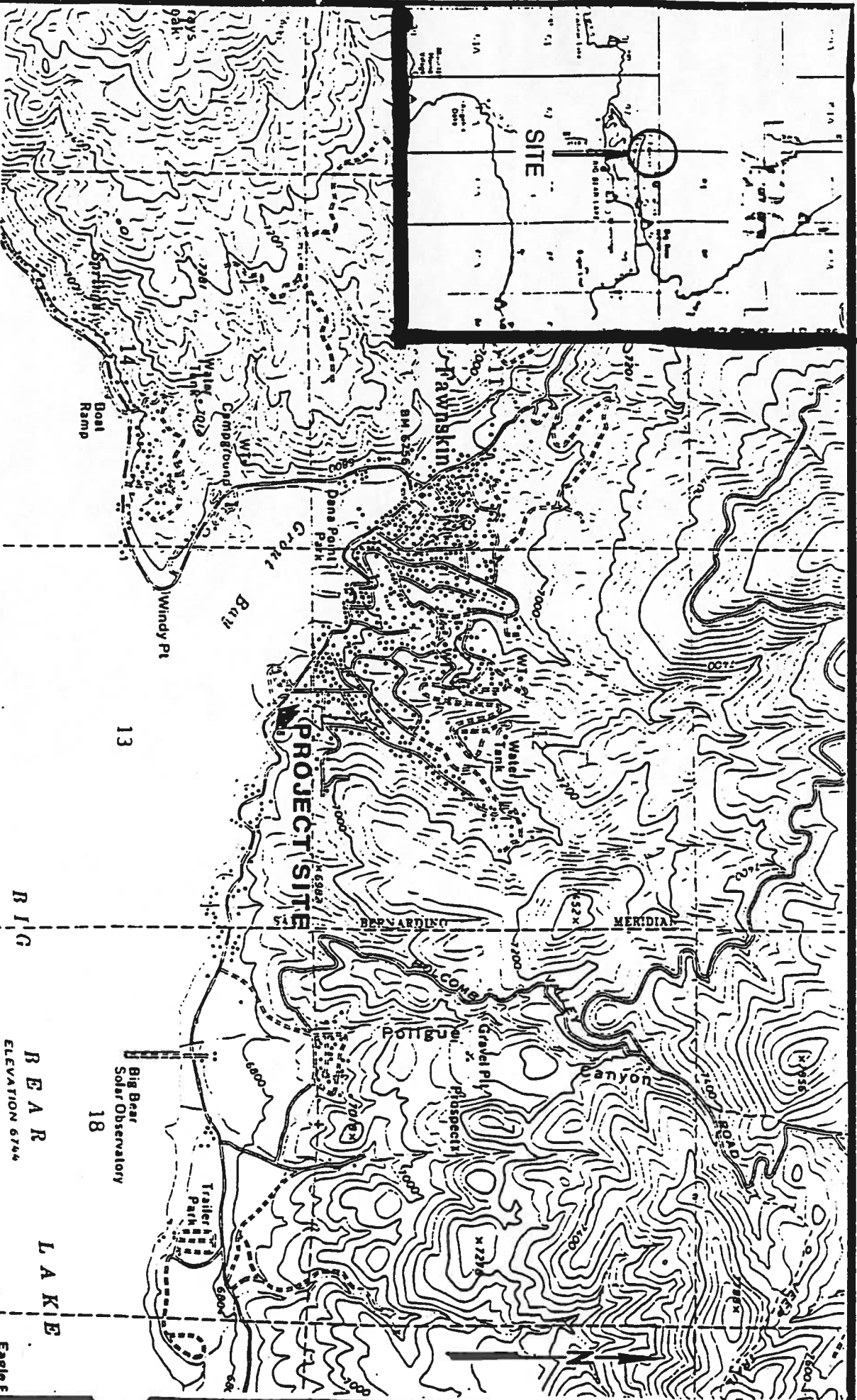
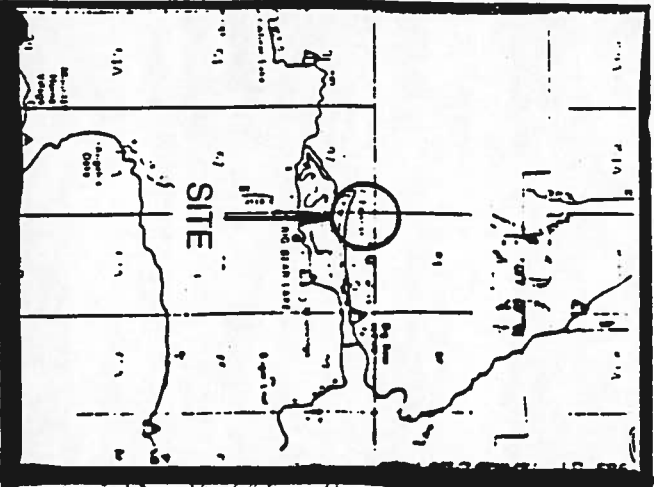

BASE MAP: 7.5' USGS FAWN SKIN QUAD

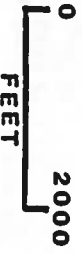

# TOPOGRAPHY OF THE PROJECT AREA

APPLICANT: SITE DESIGN ASSOCIATES

Order No. 92-3, Attachment "A"  
 Big Bear Lake Shoreline Dredging  
 Marina Point Development Associates  
 Page 5 of 8